

## THE PINAKOTHEK MUSEUMS IN THE KUNSTAREAL MÜNCHEN



### ALTE PINAKOTHEK

Daily except MON 10am–6pm | TUE 10am–8pm  
[www.pinakothek.de/en/alte-pinakothek](http://www.pinakothek.de/en/alte-pinakothek)

### NEUE PINAKOTHEK

Daily except TUE 10am–6pm | WED 10am–8pm  
[www.pinakothek.de/en/neue-pinakothek](http://www.pinakothek.de/en/neue-pinakothek)

### PINAKOTHEK DER MODERNE

Daily except MON 10am–6pm | THURS 10am–8pm  
[www.pinakothek.de/en/pinakothek-der-moderne](http://www.pinakothek.de/en/pinakothek-der-moderne)

### MUSEUM BRANDHORST

Daily except MON 10am–6pm | THURS 10am–8pm  
[www.museum-brandhorst.de/en](http://www.museum-brandhorst.de/en)

### SAMMLUNG SCHACK

WED–SUN 10am–6pm | Every 1st and 3rd WED  
in the month 10am–8pm  
[www.pinakothek.de/en/sammlung-schack](http://www.pinakothek.de/en/sammlung-schack)

# ORIENTATION ENGLISH

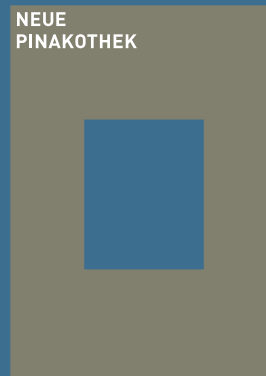

## DEAR VISITORS,

We hope you have an exciting visit and request that you please do not touch the artworks. Please put umbrellas, large bags (bigger than A4) and backpacks in the lockers or check them into the cloakroom located in the basement. Smoking, eating and drinking in the museum is strictly prohibited. The taking of photos is allowed for private use only, without the use of flash and/or tripod. Visitors are kindly requested not to use mobile phones in the exhibition areas. The museum is under video surveillance.

Thank you very much.

## The Management

Further examples of 19th century art can be found in the Sammlung Schack. The intimate, unique in its character collection offers an overview from Romanticism to the Idealism of the German artists in Rome with major works by Moritz von Schwind, Carl Spitzweg, Arnold Böcklin and Anselm Feuerbach.

### Sammlung Schack

Prinzregentenstraße 9  
D 80538 Munich  
T +49.(0)89.238 05-224  
[www.pinakothek.de/en/sammlung-schack](http://www.pinakothek.de/en/sammlung-schack)  
WED–SUN 10am–6pm  
Every 1st and 3rd WED in the month from 10am–8pm  
Information about the opening hours on public holidays is available on our website

## NEUE PINAKOTHEK

Barer Straße 29  
D 80799 Munich  
T +49.(0)89.238 05-195  
[www.pinakothek.de/en/neue-pinakothek](http://www.pinakothek.de/en/neue-pinakothek)  
[www.facebook.com/pinakotheken](https://www.facebook.com/pinakotheken)

### Gallery Hours

Daily except TUE 10am–6pm | WED 10am–8pm  
Closed: December 24th, 25th and 31st | Shrove Tuesday, May 1st

### Admission

You will find complete information about admission charges on our website, [www.pinakothek.de/en](http://www.pinakothek.de/en) at »Visitor Information and Services«.

Valid from September 2015. Temporary alterations are possible.

### Guided Tours

The schedule of guided tours is published in our quarterly programme guide, as well as on the internet at [www.pinakothek.de/en](http://www.pinakothek.de/en). We would be pleased to arrange a guide for your private tour. For further information, please visit [www.pinakothek.de/en/booking](http://www.pinakothek.de/en/booking) or call T +49.(0)89.235 05-284.  
Please register your group, even if you do not wish to book a guided tour.

### Restaurant Hunsinger in the Neue Pinakothek

Daily except TUE from 11am–1am | SUN 11am–6pm  
(in good weather, the terrace is also open in the evening)  
T +49.(0)89.242 90-204  
[www.restauranthunsinger.com](http://www.restauranthunsinger.com)

# TOUR

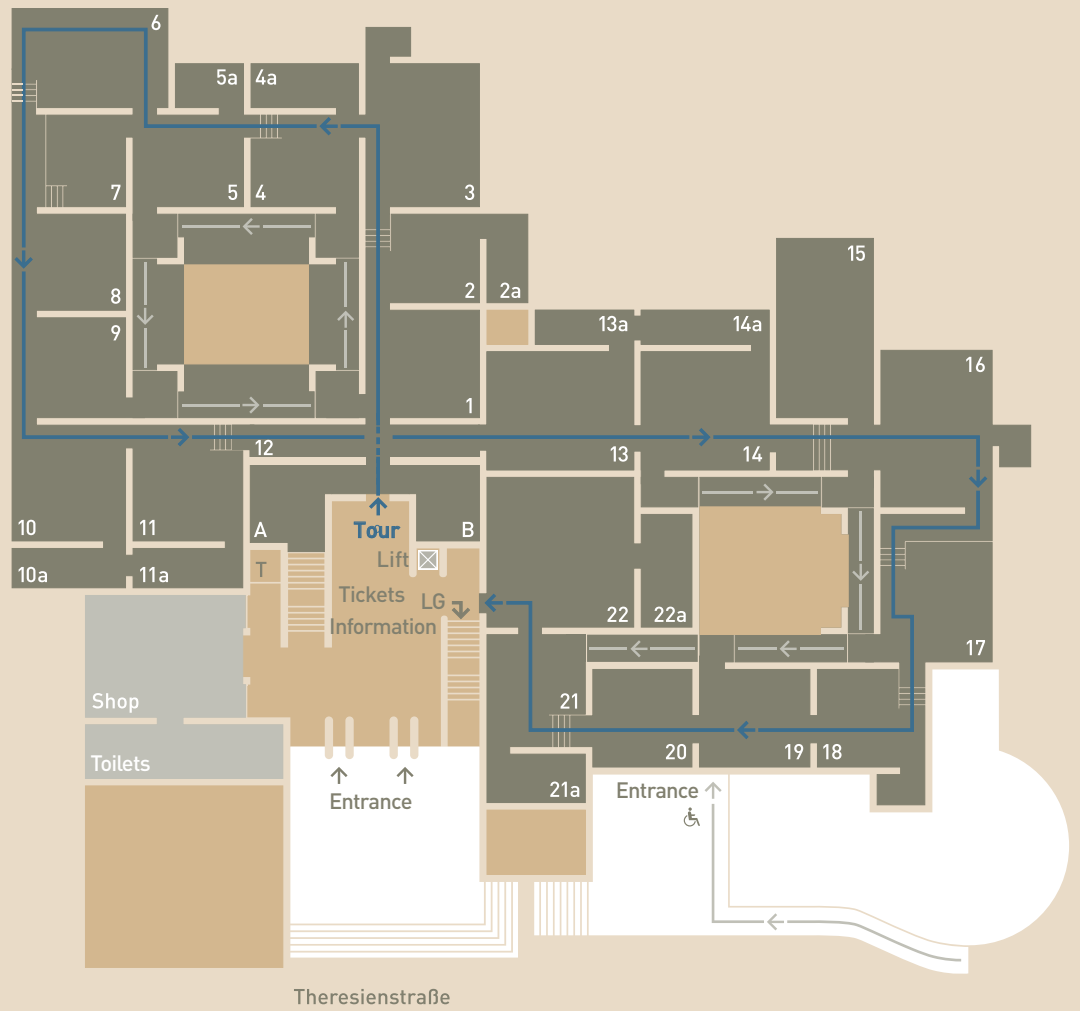

## TOUR

### Room A History of the Neue Pinakothek – Documentation

- |         |   |         |   |
|---------|---|---------|---|
| 1, 2    | Art around 1800   Antonio Canova, Jacques-Louis David, Francisco José de Goya y Lucientes, Anton Graff, Angelika Kauffmann, Anton Raphael Mengs               | 12      | Genre and Landscape Painting from Ludwig I's Collection   |
| 2a      | English and French Painting   John Constable, Jean-Baptiste Greuze, Jean-Etienne Liotard  | 13      | Carl Theodor von Piloty and History Painting  |
| 3       | English Painting from Hogarth to Turner   Thomas Gainsborough, William Hogarth, Thomas Lawrence, Joshua Reynolds, George Stubbs, William Turner, David Wilkie | 13a     | Gründerzeit Painting   Franz von Defregger, Wilhelm von Kaulbach, Albert von Keller, Hans Makart, Mihály von Munkácsy |
| 4, 4a   | German Artists in Rome   Peter von Cornelius, Heinrich Maria von Hess, Ferdinand Olivier, Friedrich Overbeck, Wilhelm von Schadow                             | 14, 14a | Landscape Painting of the Munich and Hague School   |
| 5       | Landscape Painting in Rome   Franz Ludwig Catel, Joseph Anton Koch, Johann Christian Reinhart, Ludwig Richter   | 15      | Hans von Marées, Adolf von Hildebrand   |
| 5a      | Johann Christian Reinhart – Views of Rome   | 16      | Arnold Böcklin, Anselm Feuerbach, Hans Thoma  |
| 6       | Carl Rottmann – Greek Landscapes  | 17      | Adolph von Menzel and the German Realists<br>Lovis Corinth, Max Liebermann, Max Slevogt, Fritz von Uhde               |
| 7, 8    | Art at the Court of Ludwig I.   Peter von Hess, Leo von Klenze, Domenico Quaglio, Carl Rottmann, Joseph Stieler   | 18      | Wilhelm Leibl and his Circle  |
| 9       | Early Romantic Art in Dresden and Berlin   Carl Blechen, Johan Christian Dahl, Caspar David Friedrich, Georg Friedrich Kersting, Karl Friedrich Schinkel      | 19      | Edouard Manet, Paul Cézanne and the French Impressionists   |
| 10, 10a | French Painting from Romanticism to Realism   Gustave Courbet, Honoré Daumier, Eugène Delacroix, Théodore Géricault, Jean François Millet, Carle Vernet       | 20      | Post-Impressionism and Symbolist Landscape Painting<br>Henry van de Velde, Theo van Rysselberghe, Ferdinand Hodler    |
| 11, 11a | Biedermeier and Early Realism   Heinrich Bürkel, Ferdinand von Rayski, Moritz von Schwind, Carl Spitzweg, Ferdinand Georg Waldmüller                          | 21      | Vincent van Gogh, Paul Gauguin, Paul Sérusier   |
|         |   | 21a     | Symbolist Painting   Fernand Khnopff, Odilon Redon, James Ensor, Walter Crane, George Frederick Watts                 |
|         |   | 22      | The New Century   Pierre Bonnard, Claude Monet, Ferdinand Hodler, Lovis Corinth                                       |
|         |   | 22a     | The New Style   Gustav Klimt, Egon Schiele, George Minne  |
|         |   | UG      | Room C   Open Storage<br>Cloakroom, Lockers<br>Restaurant Hunsinger in the Neue Pinakothek                            |

Temporary alterations are possible